

* Marker Configurations

The VCS:Pro rig needs four markers total. Place one marker on top of the HD monitor and one on either side.

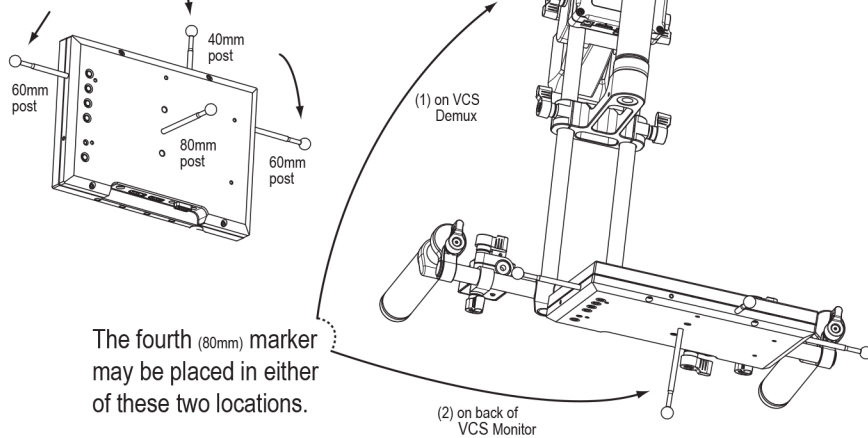

4. Software Compatibility & Usage

Windows 7 is preferred. Windows Vista and XP operating systems are supported.

The Insight VCS system is intended for use with NaturalPoint's MotionBuilder and Maya VCS plugins. Buttons and joysticks can be mapped for extensive camera control. See the MotionBuilder and Maya plugin manuals at OptiTrack.com for additional information.



Friendly Customer Service

If you have any difficulties after reviewing the documentation, visit our website or call 1.541.753.6645 between 9AM-5PM PT.

Visit www.OptiTrack.com for the latest software support, sample code and product news.

OptiTrack.com

OptiTrack®

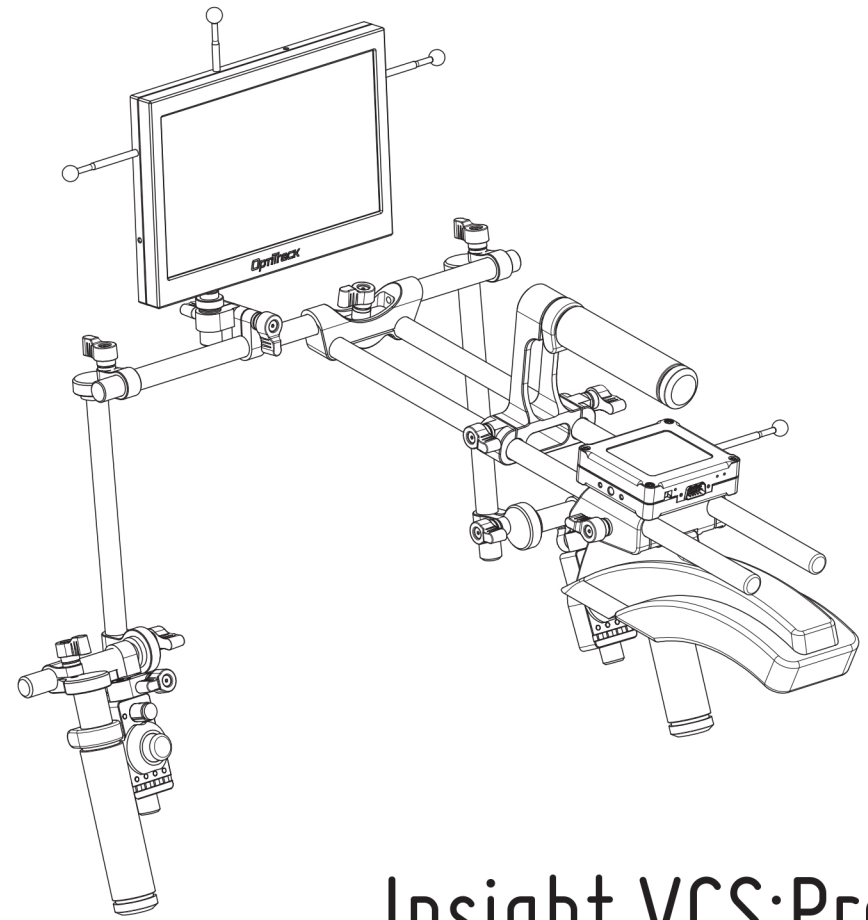

Insight VCS:Pro quick start guide